

Linear Potentiometer Slim Body Series

- Measuring range 10 - 200 mm
- Long mechanical life
- Excellent repeatability <0.01 mm
- Infinite resolution
- 2 kOhm: 10 - 50 mm
5 kOhm: 75 - 200 mm

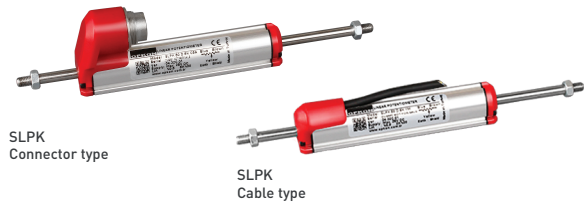

Technical Specifications

| | |
|-----------------------------|---|
| Measurement stroke | 10 - 200 mm |
| Linearity | ±%0.5 (≤75 mm), ±%0.2 (100-125 mm), ±%0.1(130-200 mm) |
| Repeatability | < 0.01 mm |
| Resolution | Infinite |
| Resistance | 2 kOhm : 10 - 50 mm 5 kOhm : 75 - 200 mm |
| Resistance tolerance | ± %20 |
| Load resistance | 100 kOhm min. |
| Recommended wiper current | <1 µA |
| Permissible applied voltage | 28 VDC max. |
| Electrical connections | Connector or 1 m cable output |
| Displacement speed | < 5 m/s |
| Mechanical life | 100 million movement |
| Case dimensions | Ø18 mm |
| Case material | Anodized aluminium |
| Rod material | Stainless steel |
| Rod diameter | Ø5 mm |
| Mechanical fixing | Variable brackets |
| Protection level | IP 40 |
| Operating temperature | -20°C ... +80°C |
| Storage temperature | -30°C ... +90°C |

Mechanical Specifications

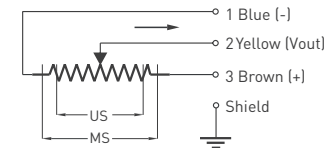
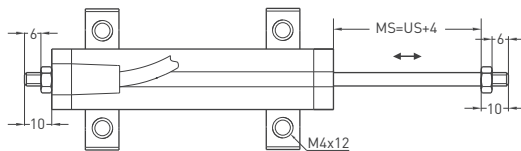
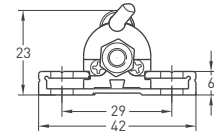
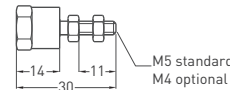
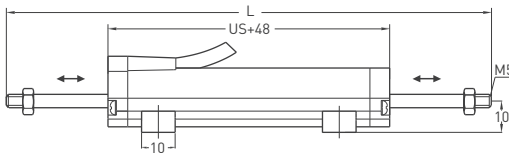

| | | | | | | | | | |
|---------------------------|----|-----|-----|-----|-----|-----|-----|-----|-----|
| SLPKS (mm) | 10 | 25 | 50 | 75 | 100 | 125 | 150 | 175 | 200 |
| US (Usefull stroke) | 10 | 25 | 50 | 75 | 100 | 125 | 150 | 175 | 200 |
| MS (Mechanical stroke) | 14 | 29 | 54 | 79 | 104 | 129 | 154 | 179 | 204 |
| L (Total length) | 92 | 122 | 172 | 222 | 272 | 322 | 372 | 422 | 472 |

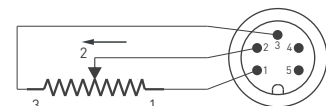

Ordering Procedure

| Model | Measurement stroke (mm) | Linearity (%) | Resistance (kOhm) | Connector / Cable |
|-------|-------------------------|---|--|--|
| SLPK | 150 | C | 5K | 1M |
| SLPK | 10 - 200 mm | A: ±%0.5 (≤75 mm), B: ±%0.2 (100 - 125 mm), C: ±%0.1 (130 - 200 mm) | 2K : 2 kOhm (10-50 mm) 5K : 5 kOhm (75-200mm) | 1M: 1 meter cable(standard) 1M5: 1.5 meter cable 2M: 2 meter cable CN5B: M16, 5 pin connector |