

# CBX

## COMPRESSION LOAD CELLS - LOW PROFILE



Manufactured according to OIML R60 standards

Capacity from 15000 kg to 50000 kg

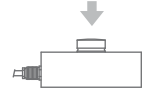

### MOUNTING KITS



- 17-4 PH STAINLESS STEEL
- COMBINED ERROR  $\leq \pm 0.03\%$
- PROTECTION CLASS IP68

CAPACITY	kg	IECEx	Ex	EAC	NET WEIGHT OF LOAD CELL (kg)	CODE
15000		•	•	•	1.4	CBX15000
30000		•	•	•	2.2	CBX30000
50000		•	•	•	3.8	CBX50000
		ON REQUEST				

### CERTIFICATIONS

#### CERTIFICATIONS ON REQUEST

✓	Calibration report (ACCREDIA LAT traceability)
Ex	ATEX II 1GD (zone 0-1-2-20-21-22)
IECEx Ex	IECEx II 1GD (zone 0-1-2-20-21-22)
ERC	Complies with the Eurasian Custom Union regulations (Russia, Belarus, Kazakhstan)

### TECHNICAL FEATURES

Material	17-4 PH stainless steel		
Nominal load (E max)	15000 - 30000 - 50000 kg		
Combined error	≤ ±0.035%		
Protection class	IP68		
Rated output	2 mV/V ±0.1%	Input resistance	700 Ω ±5
Temperature effect on zero	0.005% °C	Output resistance	700 Ω ±5
Temperature effect on span	0.003% °C	Zero balance	±1%
Compensated temperature range	-10 °C / +50 °C	Insulation resistance	> 10000 MΩ
Operating temperature range	-20 °C / +70 °C	Safe overload (% of full scale)	150%
Creep at nominal load in 30 minutes	0.03%	Ultimate overload (% of full scale)	300%
Max supply voltage without damage	15 V	Deflection at nominal load	0.4 mm

### ELECTRICAL CONNECTIONS

Cable length	10 m
Cable diameter	5 mm
Cores	4/6 x 0.25 mm <sup>2</sup>

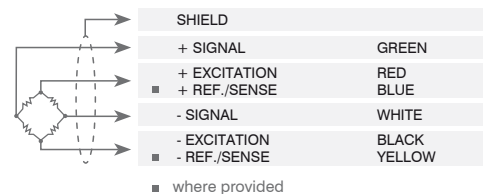



### OPTIONS ON REQUEST

#### DESCRIPTION

Two redundant strain gauges Wheatstone bridges (350 Ω) with two output cables; for dual safety systems

### COMPLEMENTARY ACCESSORIES

	DESCRIPTION	CODE
	AISI 304 stainless steel threaded upper base for compression load cells. M12x1.75 mm	BASESUPFIL
	AISI 304 stainless steel turned lower base for compression load cells. Ø110x22 mm Ø140x23 mm	BINF100 BINF126
	Lower plate and turned upper base in AISI 304 stainless steel. Load cell capacity: 15000 kg.	BASESUP P10000
	Turned upper and lower bases in AISI 304 stainless steel. Load cell capacity: 15000 kg.	BASESUP BASEINF
	Lower plate and turned lower base in AISI 304 stainless steel. Load cell capacity: 15000 kg.	BASEINF PIASTRA200
	AISI 304 stainless steel adapter for mounting kits: - V15000      Ø110x6 mm - V30000      Ø126x9 mm - V100000     Ø165x29 mm	ADAT100CBX15T ADAT126CBX30T ADAT165CBX50T

### DIMENSIONS (mm)

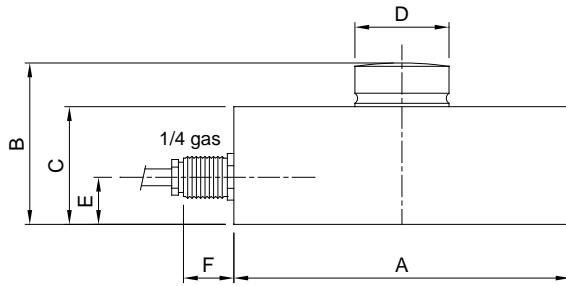

kg	15000	30000	50000
A	Ø82	Ø100	Ø126
B	44	48	54
C	32	35	40
D	Ø22	Ø28	Ø35
E	14	14	14
F	15	15	15

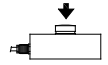

**P10000**

**BASESUP**

**BASEINF**

**PIASTRA200**

**BASESUPFIL**

**BINF**

	A	B	C	D
BINF100	Ø110	22	Ø102	2
BINF126	Ø140	23	Ø128	3